

## ETG-CHS-EM Emergency Battery

### PRODUCT DESCRIPTION:

The LED emergency drivers is designed for use with CHS-H4 High Bay fixtures, with 0/1-10V dimmable LED drivers. It allows the High Bay to be used for both normal and emergency operation.

### FEATURES:

1. UL listed for the U.S. and Canada
2. Listed for factory or field installation - UL924 & CSA C22.2 No. 141
3. Constant power output: 30W/40W/60W
4. Multi-voltage input: 100-347Vac, 50/50 Hz
5. Battery protections: over charge protection, over discharge protection, short circuit protection
6. Self-testing monthly
7. Wireless remote control for emergency testing
8. Easy installation, directly connect to AC input of CHS-H4 High Bay
9. 5 year warranty
10. Meets CEC Title 20 standards

### DIAGRAM:

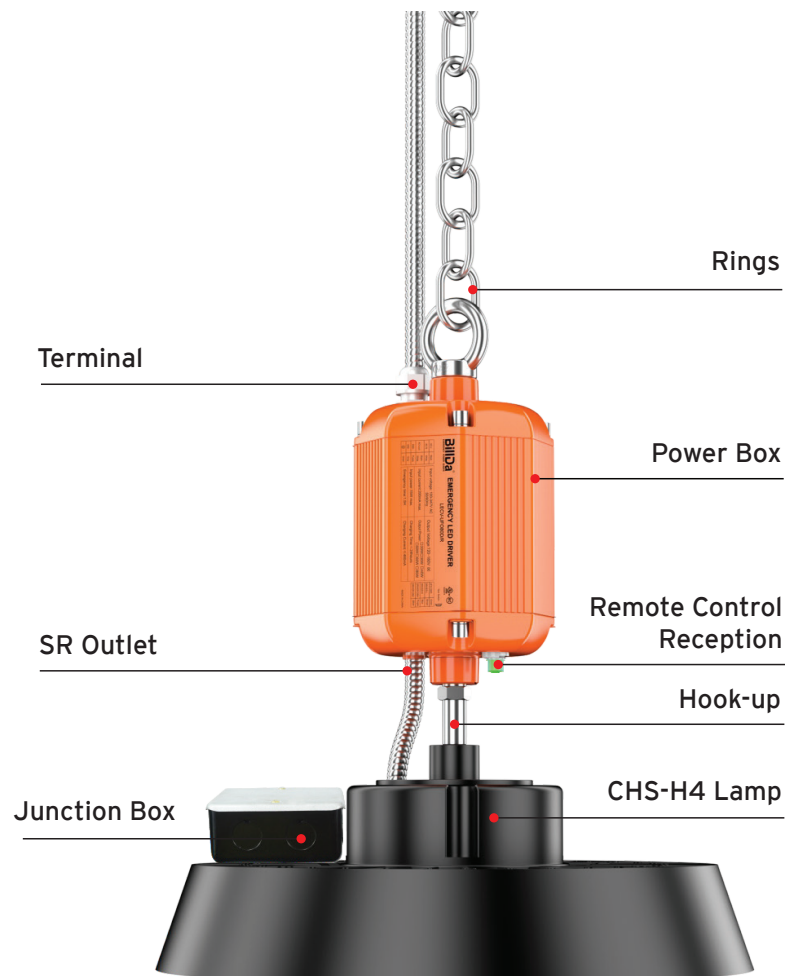

**SPECIFICATIONS:**

<b>Input Voltage</b> 100-347VAC, 50/60Hz	<b>Emergency Operation</b> 90 Minutes
<b>Output Voltage</b> 120-180Vdc	<b>Test Switch/Charging Indicator Light</b> Remote Control
<b>Input Current</b> 460 mA (Max)	<b>Battery</b> Li-ion Battery
<b>Input Power</b> 15 Watts (Max)	<b>Recharge</b> ≤24 Hrs
<b>Output Power</b> 30W/40W/60W	<b>Dimensions</b> L 297.3mm X W 142.5mm X H 108.2mm
<b>Ambient Temperature</b> -30°C to 60°C	<b>Weight</b> 2 kg

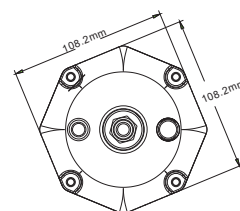
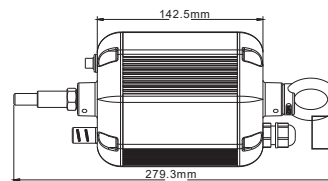
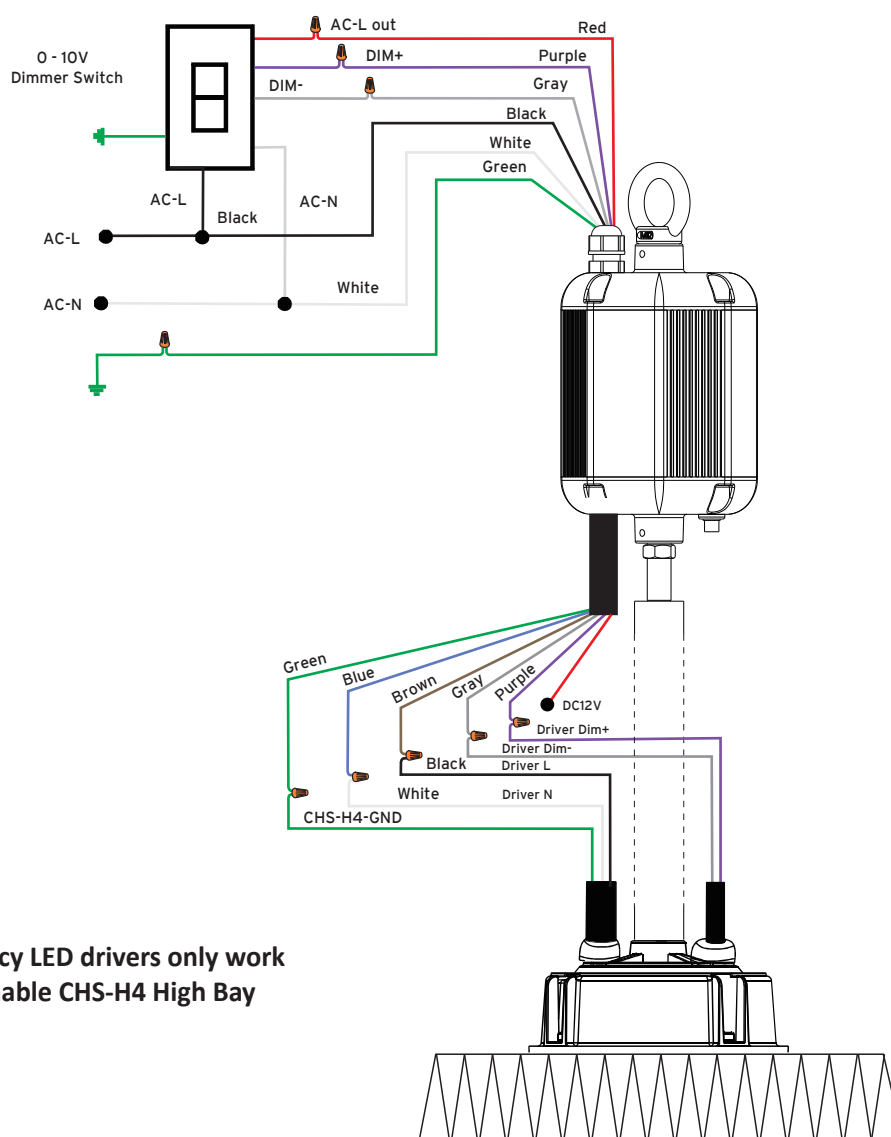
**WIRING DIAGRAM:**

**PLEASE NOTE:** Emergency LED drivers only work with the 0/1-10V Dimmable CHS-H4 High Bay

# ETG-CHS-EM

## Read and Follow All Safety Instructions

### SAFETY INSTRUCTIONS:

- Risk of fire or electric shock. Luminaire wiring and electrical parts may be damaged when drilling for installation of LED Emergency Backup. Check for enclosed wiring and components.
- Risk of fire or electric shock. This LED Emergency Backup installation requires knowledge of luminaire electrical systems. **If not qualified, do not attempt installation. Contact a qualified electrician.**
- Before installing, make certain the AC power to the fixture is off.
- The electrical rating of this product is 100-347Vac. Installer must confirm that there is 100-347Vac to the fixture before installation.
- To prevent electrical shock only mate unit connector after installation is complete and before the AC power to the fixture is back on.
- Do not use outdoors.
- This LED Emergency Backup unit requires an un-switched AC power source of 100-347Vac, 50/60Hz. The AC driver must be on the same branch circuit as the LED Emergency Backup unit.
- Do not let power supply cords touch hot surfaces.
- Do not mount near gas or electric heaters.
- Do not connect battery pack connector until all other wiring is complete and AC power is on.
- Equipment should be mounted in locations and at heights where it will not be subjected to tampering by unauthorized personnel.
- The use of accessory equipment is not recommended by the manufacturer and may cause an unsafe condition.
- Do not use this equipment for other than its intended use.
- Use with grounded, UL Listed, dry or damp location rated fixtures.
- Make sure the load is not greater than 300W, more than this parameter will result in shortening discharge time.
- Repairs and maintenance must be carried out by qualified personnel.