

Product Description

These flat panel LED fixtures reorient the light source to the panel and ensure brightness, providing a skylight-like appearance. At 7/16" thick, our flat panels are extremely light and minimal - making them easy to install, and aesthetically pleasing. Units are designed to mount in ceiling grids or hang by hooks for easy installation in tight places like ceilings with shallow plenums.

Precautions

- ⚠ WARNINGS**
- ⚠ Risk of electrical shock.** Disconnect power before servicing or installing product.
Risque de choc électrique. Coupez l'alimentation avant l'entretien ou l'installation du produit.
- ⚠ Risk of damage.** Wiring instructions must be followed or fixture may be damaged.
Risque de lésions. Instructions de câblage doivent être suivies ou un appareil peuvent être endommagés.
- ⚠ Risk of injury or damage.** Unit will fall if not installed properly. Follow installation instructions.
Risque de blessures ou de dommages. Unité va tomber s'il n'est pas installé correctement. Suivez les instructions d'installation.
- ⚠ Risk of injury.** Wear safety glasses and gloves during installation and servicing.
Risque de blessure. Porter des lunettes de sécurité et des gants lors de l'installation et de l'entretien.

MODEL	WEIGHT	DIMENSIONS
2x4 Flat Panels	8.0 lbs.	47.7" L x 23.8" W x 0.4"H
2x2 Flat Panels	4.0 lbs.	23.8" L x 23.8" W x 0.4"H
1x4 Flat Panels	4.0 lbs.	47.7" L x 11.7" W x 0.4"H

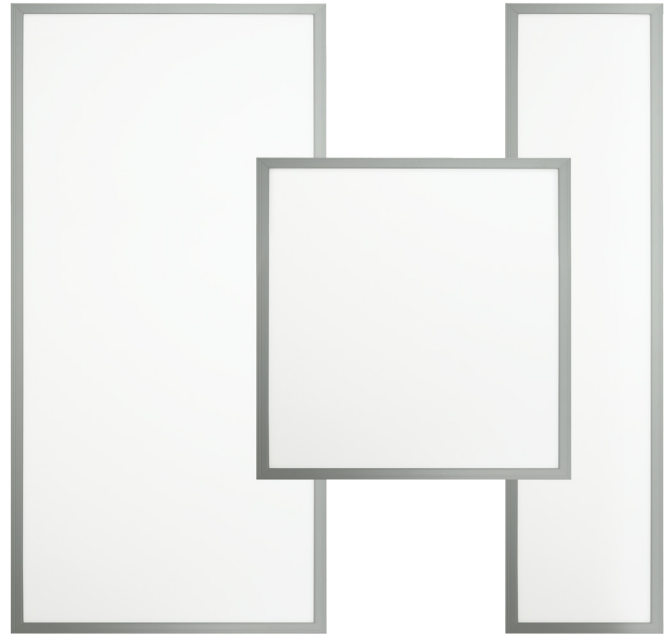

Back of Flat Panel showing wiring/power casing

Unit Installation - Please follow steps in order*



After unpacking flat panel and wiring/power casing, lay the flat panel on a clean surface with the barrel connector facing up. Connect the wiring/power casing to the flat panel via the barrel connector.

***Installation is shown on a 2x4 panel. All other panels follow the same procedure.**



Conceal the wiring inside the casing to prevent pinching. Insert the casing into the extrusion lip.

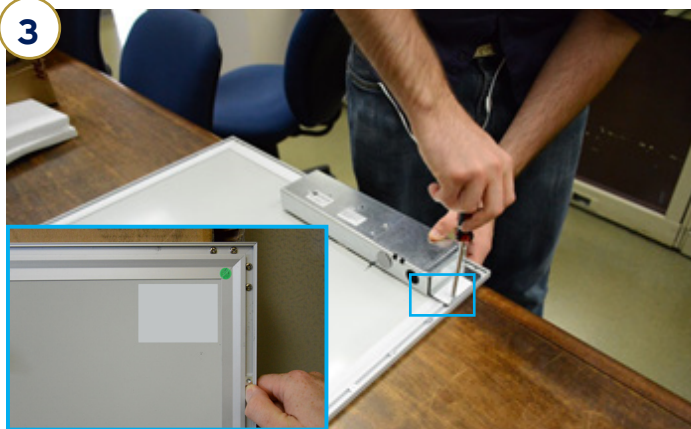

Use a screwdriver to punch through the paper label. Use the provided screw to align with the slotted nut shown to attach the wiring/power casing.



The wiring/power casing will look like this.



Open casing cover to access AC wiring.

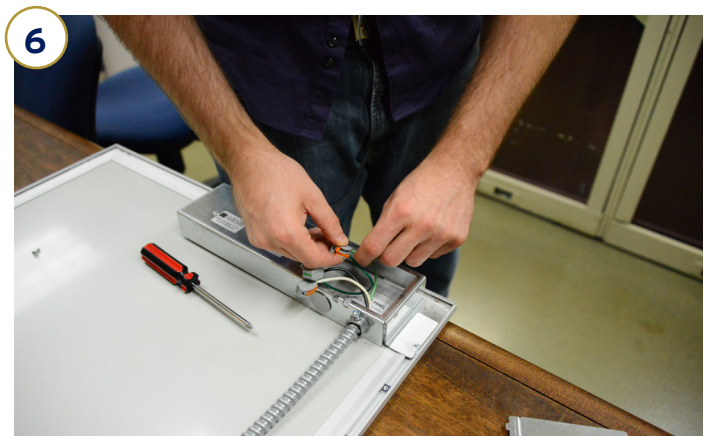

Connect the black (live), white (neutral) and green (ground) wires of the AC line to the casing. Dimming controller optional (see below). Replace the casing cover before hanging unit or placing unit in the ceiling.



For wire hanging or additional support in a ceiling grid, use four provided mounting brackets and move the slotted nuts into the desired location near the corners.



Thread wire through the hole in the mounting bracket.

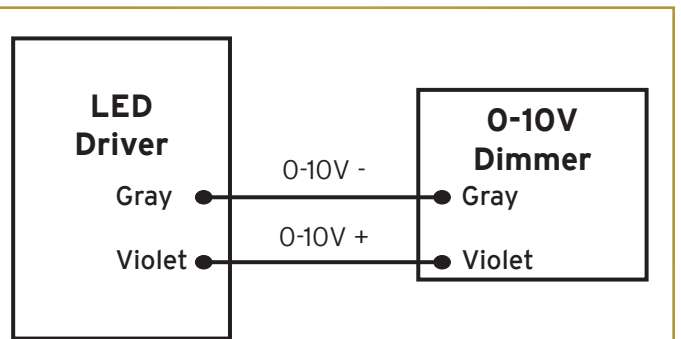

Diagram A

A separate knockout is available to connect the dimming controller. Follow Diagram A to connect a 0-10V dimmer.

Replace the casing cover before hanging unit or placing unit in the ceiling.